

Base Bid

ROSS/FOWLER
 ARCHITECTS
 1000 S. GARDNER BLVD.
 MEMPHIS, TN 38104
 (901) 525-1100

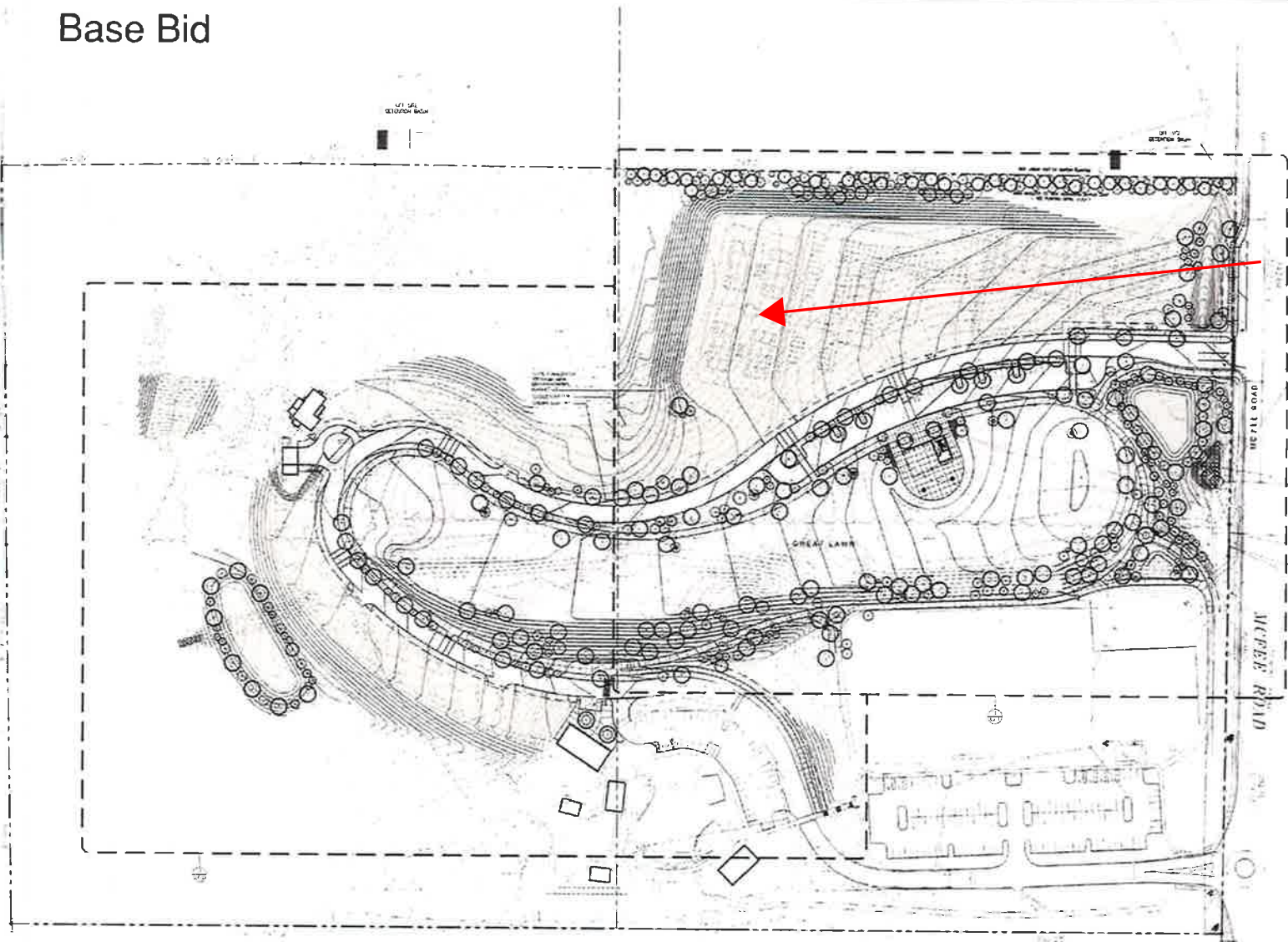

Location
 of
 Alternate 2

PLANTING NOTES

1. THE LOCATION OF ALL PLANTING AND ARRANGEMENTS SHOWN ON THIS PLAN SHALL BE THE RESPONSIBILITY OF THE CONTRACTOR AT THE TIME OF CONSTRUCTION. THE CONTRACTOR SHALL BE RESPONSIBLE FOR PROVIDING ALL MATERIALS FROM SOURCE AS REQUIRED BY THESE PLANS. CONSTRUCTION SHALL BE IN ACCORDANCE WITH THE SPECIFICATIONS AND TO REFLECT THE QUALITY WHICH SHOULD BE MAINTAINED TO THE SATISFACTION OF THE OWNER.
2. THE TREE SIZE AND SPACING ON THIS PLAN SHALL BE THE BASIS FOR THE CONTRACTOR'S PLANTING. THE CONTRACTOR SHALL BE RESPONSIBLE FOR THE SELECTION OF THE SPECIES AND THE SIZE OF THE PLANTS TO BE PLANTED.
3. ALL PLANTING SHALL BE DONE BY THE CONTRACTOR. THE CONTRACTOR SHALL BE RESPONSIBLE FOR THE SELECTION OF THE SPECIES AND THE SIZE OF THE PLANTS TO BE PLANTED.
4. THE LOCATION OF ALL PLANTS SHALL BE SHOWN BY THE CONTRACTOR. THE CONTRACTOR SHALL BE RESPONSIBLE FOR THE SELECTION OF THE SPECIES AND THE SIZE OF THE PLANTS TO BE PLANTED.
5. PLANTING SHALL BE DONE BY THE CONTRACTOR. THE CONTRACTOR SHALL BE RESPONSIBLE FOR THE SELECTION OF THE SPECIES AND THE SIZE OF THE PLANTS TO BE PLANTED.
6. THE CONTRACTOR SHALL BE RESPONSIBLE FOR THE SELECTION OF THE SPECIES AND THE SIZE OF THE PLANTS TO BE PLANTED.
7. THE CONTRACTOR SHALL BE RESPONSIBLE FOR THE SELECTION OF THE SPECIES AND THE SIZE OF THE PLANTS TO BE PLANTED.
8. THE CONTRACTOR SHALL BE RESPONSIBLE FOR THE SELECTION OF THE SPECIES AND THE SIZE OF THE PLANTS TO BE PLANTED.
9. THE CONTRACTOR SHALL BE RESPONSIBLE FOR THE SELECTION OF THE SPECIES AND THE SIZE OF THE PLANTS TO BE PLANTED.
10. THE CONTRACTOR SHALL BE RESPONSIBLE FOR THE SELECTION OF THE SPECIES AND THE SIZE OF THE PLANTS TO BE PLANTED.



0 60 120 180

MC FEE PARK PHASE 3
 FARRAGUT, TENNESSEE



OVERALL
 PLANNING PLAN
 BASE BID
L7.0